



SUZUKI GSX-R 1300 HAYABUSA
(2008)

RACING TWIN EXHAUST SYSTEM

www.akrapovic.com

Racing exhaust system is designed for riders who demand the most from their exhaust system in terms of both quality and performance. The header tubes are formed using HYDROFORMING technology! With Akrapovic Racing twin system you will benefit from great power increase and maximum weight savings compared to stock Suzuki exhaust system.

PERFORMANCE

Measurements of the Akrapovic EVOLUTION TWIN system on the SUZUKI GSX-R 1300 HAYABUSA (without noise damper):

The system provides a linear increase throughout the entire range, and the greatest increase is at the very top of the range. We measured 188.5 HP at 10500 rpm on the rear wheel. The max. increased power is 11.5 HP at 6000 rpm.

The torque curve also reflects the exhaust system upgrade. The engine is more responsive in bottom and will provide much more torque through entire rpm range.

CONFIGURATION

The 4-2-2 configuration of the RACING system uses stainless steel for header tubes, collector and link pipe. The muffler outer sleeve is available in either carbon-fiber or titanium, while the outlet cap is available only in carbon-fiber. The interior of the muffler is also made of titanium. All parts are connected together with sleeve joints and held together with silicon-shielded tensioning springs. The muffler is attached to the motorcycle with a carbon-fiber clamp.

	PERFORMANCE		
	stock	AKRAPOVIC	max. increased power
max. rear wheel power HP / rpm <small>(measured on Dynojet ATV)</small>	179.5 / 9300	188.5 / 10500	11.5 / 6000

	CONFIGURATION		
	header tubes	collector	link pipe
material	STAINLESS STEEL	STAINLESS STEEL	STAINLESS STEEL
tube shape	CONICAL	CYLINDRICAL	CONICAL

interference crossover tubes	YES	lambda sensor	YES	
header tube inner sleeves	S.S. CNC machined	header tube flanges	ALU CNC machined	
header tubes - collector connection	SLEVE JOINT+ SILICON SHIELDED SPRING	collector / header tube - link pipe connection	SLEVE JOINT+ METAL CLAMPS	
link pipe - muffler connection	SLEVE JOINT+ SILICON SHIELDED SPRING	muffler inlet cap /outlet cap	TITANIUM / CARBON-FIBER	
muffler metal interior	TITANIUM	muffler outer sleeve	Ti or Carb. fiber	
muffler clamp	CARBON-FIBER	muffler bracket	-	
muffler insert	EU	YES	heat shield	-
	US	-	catalytic converter	-

	ADDITIONAL DATA				
	stock	AKRAPOVIC		difference	
weight comparison (kg)	21.53	S.S. link pipe	TITANIUM link pipe	stock - S.S.	stock - titanium
		8.6	-	12.93	-

noise measurements (dB / rpm)	stock	AKRAPOVIC
	91 / 4750	97.7 / 4750
possibility of periodic service without removing A.E.S.	oil	oil filter
	YES	YES
legal for street use	NO	

Technical specifications of Akrapovic exhaust systems and related products subject to change without notice.

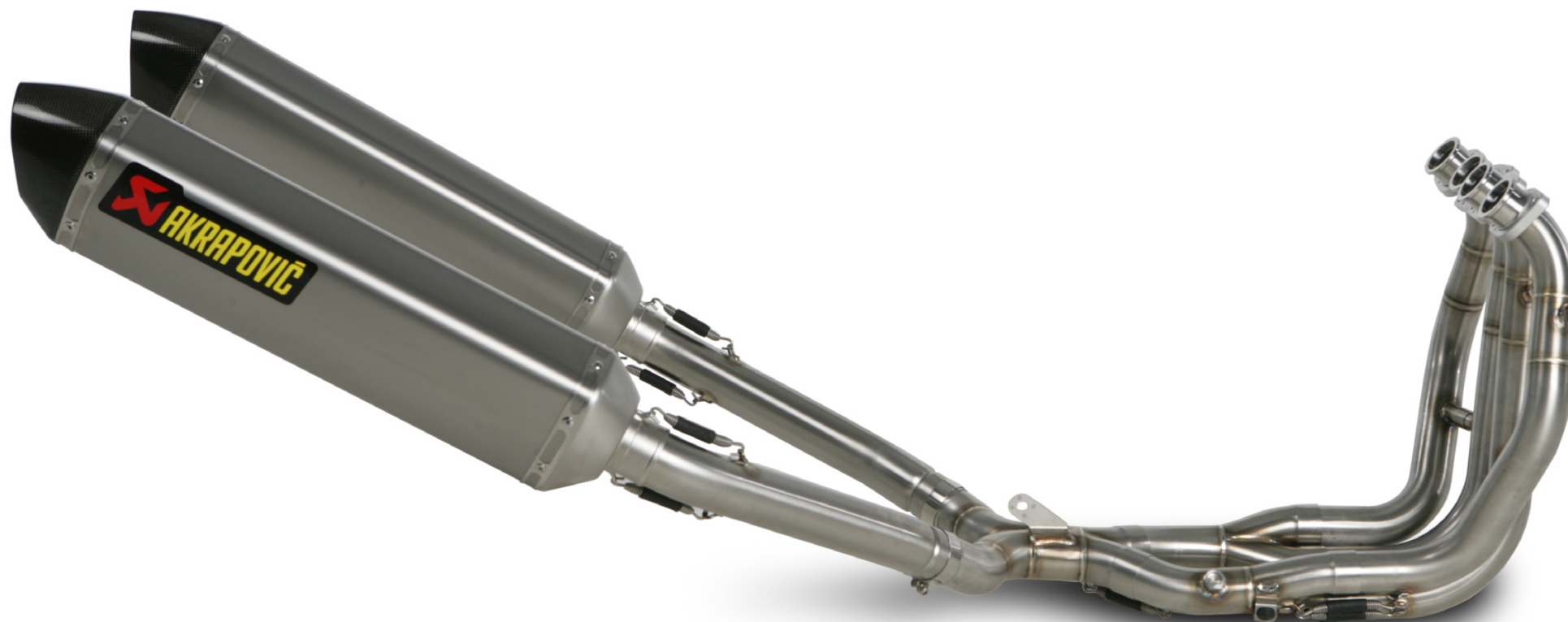

Product code: (109558) S-S13R2-RC/1
(109557) S-S13R2-RT/1



Product code: (109558) S-S13R2-RC/1
(109557) S-S13R2-RT/1

 **AKRAPOVIČ**

www.akrapovic.com
Akrapovič d.d. 2008 all rights reserved



Product code: (109558) S-S13R2-RC/1
(109557) S-S13R2-RT/1

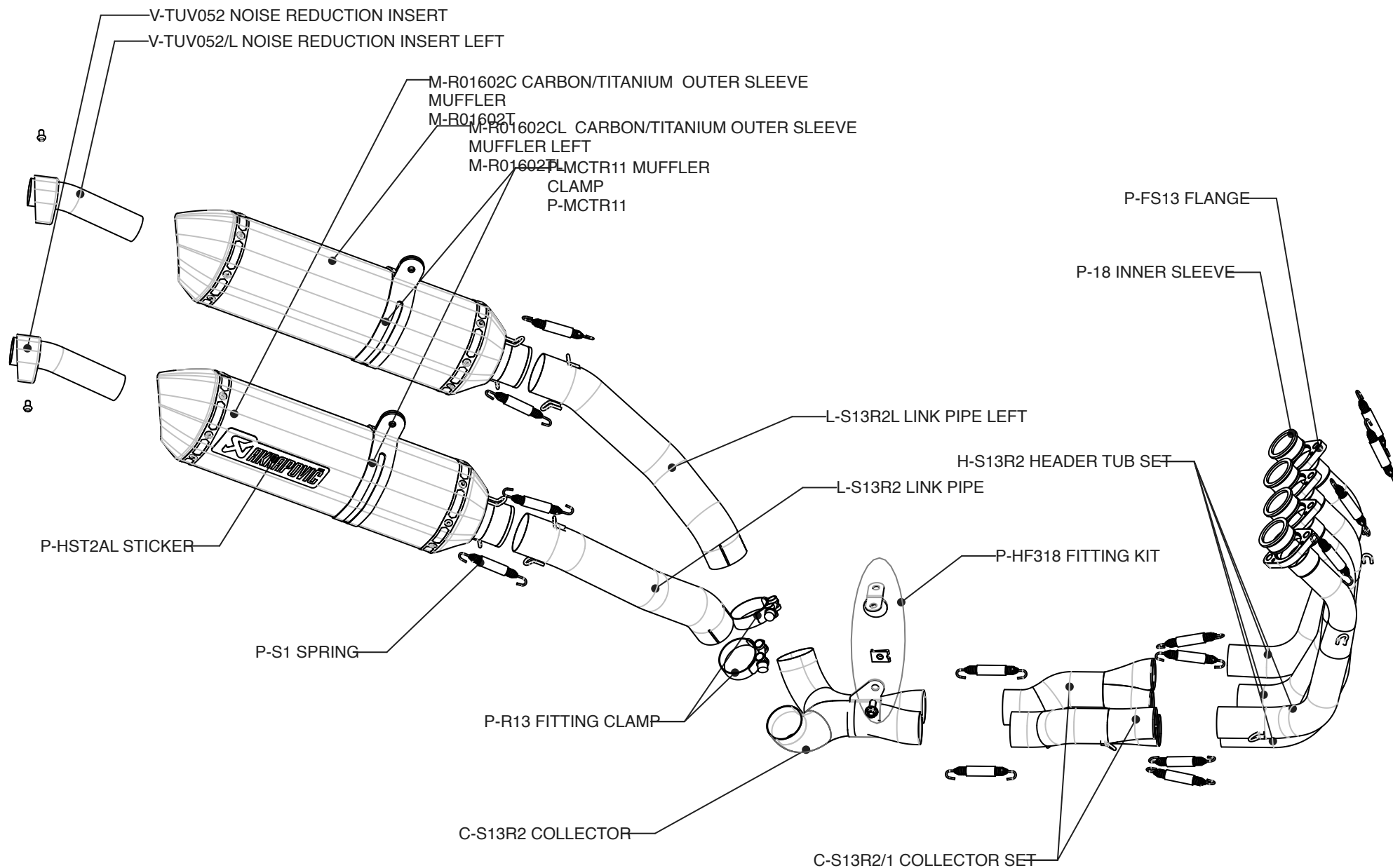

Product code: (109558) S-S13R2-RC/1
 (109557) S-S13R2-RT/1



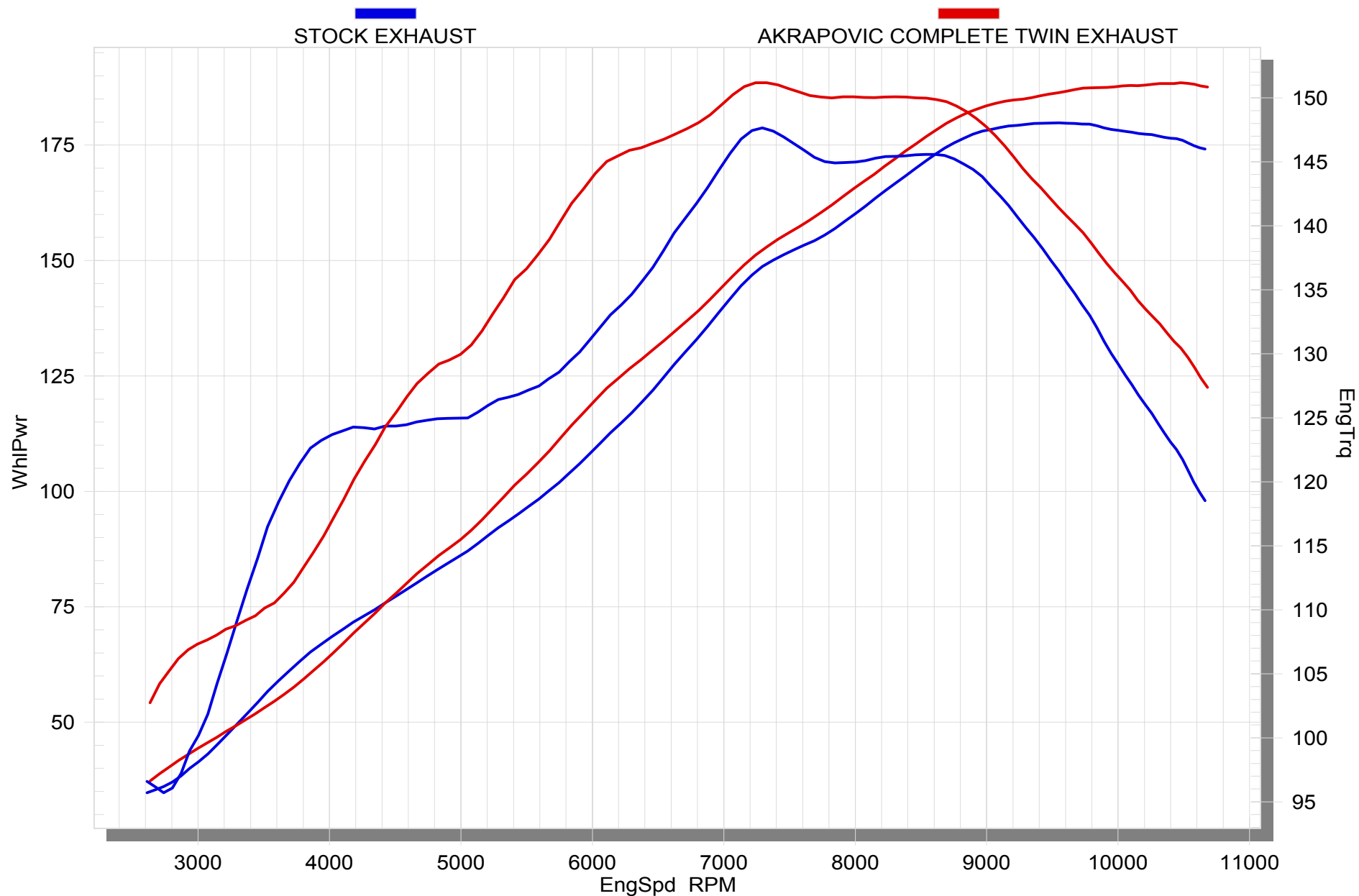

Product code: (109558) S-S13R2-RC/1
 (109557) S-S13R2-RT/1

