



Honda CRF 250R (2004, 2005)

Evolution Exhaust System

Akrapovic Evolution Exhaust System

for the Honda CRF 250R (2004, 2005)

The Akrapovic EVOLUTION system for the Honda CRF 250R will satisfy the needs of all professional MX riders. It is designed to increase performance at the adrenaline-pumping top of the rpm range. The system also conforms to FIM regulations on exhaust system noise levels for MX competition. And of course it also conforms beautifully to the lines of the Honda. For 2005, the Honda delivers even more power than the 2004 model.

PERFORMANCE

Measurements of the Akrapovic EVOLUTION exhaust system on the HONDA CRF 250 R:

Power: the power curve shows the character of the Akrapovic EVOLUTION system, with the greatest power increase coming in the range from 8000 rpm on, and extending into the overrev range, which will be very useful for experienced riders. Max. power of 33.6 HP is delivered way up at 11000 rpm. A power increase is also visible between 5400 and 7000 rpm, and from there to 8000 rpm the stock and Akrapovic curves more or less overlap.

Torque: the torque curve is similar to the power curve, with the biggest increase coming at the top of the rpm range, and extending into the falling area of the curve. The range from 5400 and 7000 rpm is also better filled by the Akrapovic exhaust system than the torque delivered by the stock exhaust.

CONFIGURATION

Akrapovic EVOLUTION components (header tube, link pipe) are made of titanium elements. The header tube is conical, while the link pipe is flared. The components are attached with a free-floating joint secured with silicon-shielded tensioning springs. The muffler-link pipe joint is welded. The muffler is made entirely of titanium, and is attached to the frame using an Akrapovic Offroad carbon-fiber clamp. The Akrapovic EVOLUTION system also comes with a carbon-fiber heat shield.

	PERFORMANCE		
	stock	AKRAPOVIC	max. increased power
max. rear wheel power HP / rpm (measured on SuperFlow Cycle Dyn)	32.4 / 10400	33.6 / 11000	1.2 / 11000

	CONFIGURATION		
	header tubes	collector	link pipe
material	TITANIUM	-	TITANIUM
tube shape	CONICAL	-	FLARED

interference crossover tubes	-	lambda sensor	-
header tube inner sleeves	STAINLESS STEEL	header tube flanges	LASER CUT S.S.
header tubes - collector connection	-	collector / header tube - link pipe connection	FREE FLOATING + SILICON SHILDED SPRING
link pipe - muffler connection	WELDED	muffler inlet cap /outlet cap	TITANIUM / TITANIUM
muffler metal interior	TITANIUM	muffler outer sleeve	TITANIUM
muffler clamp	1x CARBON-FIBER OFF ROAD	muffler bracket	-
noise damper	-	heat shield	CARBON-FIBER

OPTIONS			
link pipe	noise damper	muffler bracket	heat shield
-	-	-	-

	ADDITIONAL DATA				
	stock	AKRAPOVIC		difference	
		RACING	EVOLUTION	stock - RACING	stock - EVOLUTION
weight comparison (kg)	2.86	-	2.11	-	0.75
noise measurements (dB / rpm)	stock		AKRAPOVIC		
	98 / 5500		98 / 5500		
possibility of periodic service without removing A.E.S.	oil		oil filter		
	YES		YES		
legal for street use	NO				

Technical specifications of Akrapovic exhaust systems and related products subject to change without notice.

Akrapovic Evolution Exhaust System for the Honda CRF 250R (2004, 2005)



Akrapovic Exhaust System Technology copyright 2004, all rights reserved

Off-Road
Program



ANTI-SEIZING GREASE

CARBON-FIBER
MUFFLER CLAMP



Akrapovic Evolution Exhaust System for the Honda CRF 250R (2004, 2005)



Akrapovic Exhaust System Technology copyright 2004, all rights reserved

Off-Road
Program

Akrapovic Evolution Exhaust System for the Honda CRF 250R (2004, 2005)



Akrapovic Exhaust System Technology copyright 2004, all rights reserved

Off-Road
Program

Akrapovic Evolution Exhaust System

for the Honda CRF 250R (2004, 2005)

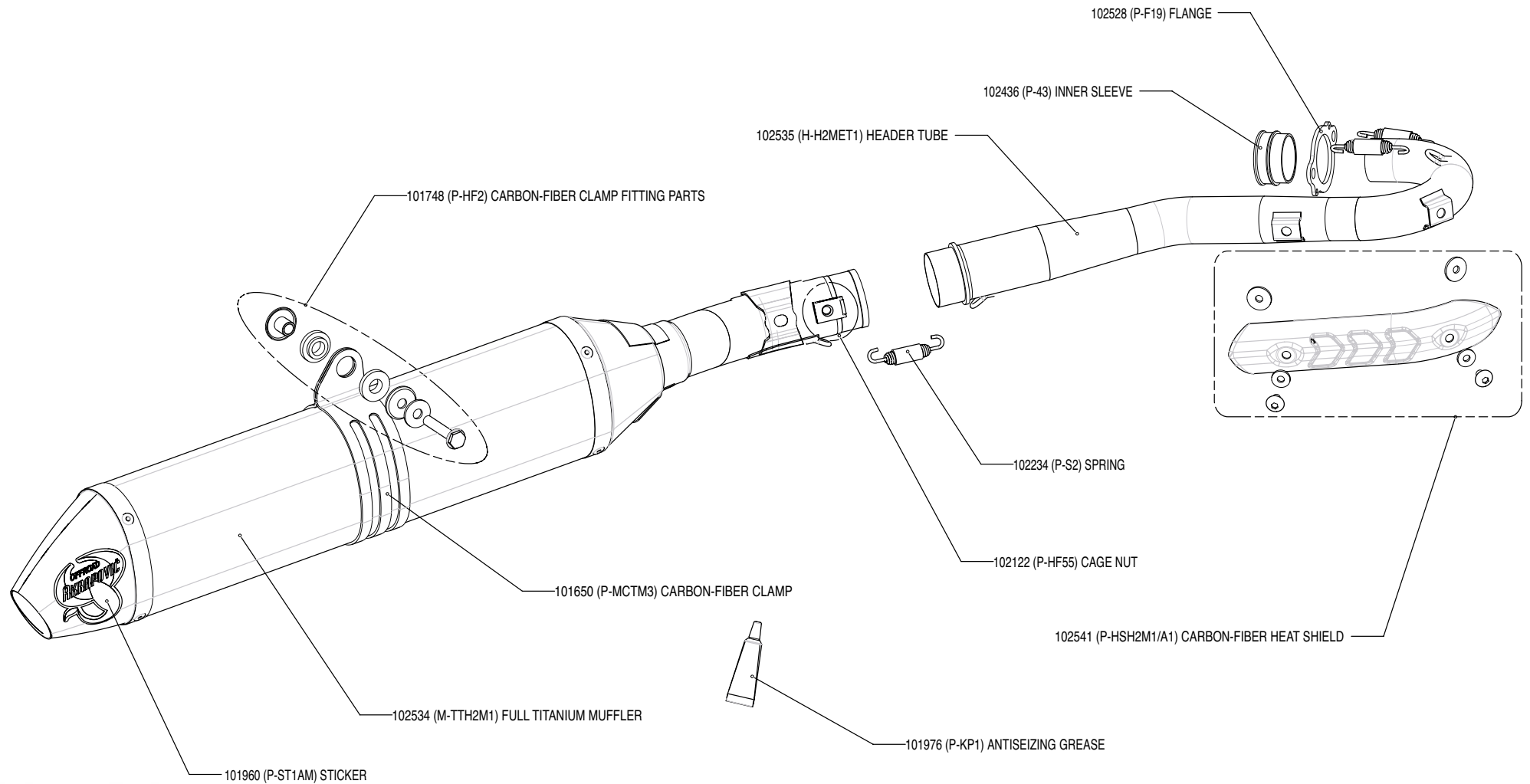

Akrapovic Exhaust System Technology copyright 2004, all rights reserved

Off-Road Program

Akrapovic Evolution Exhaust System for the Honda CRF 250R (2004, 2005)

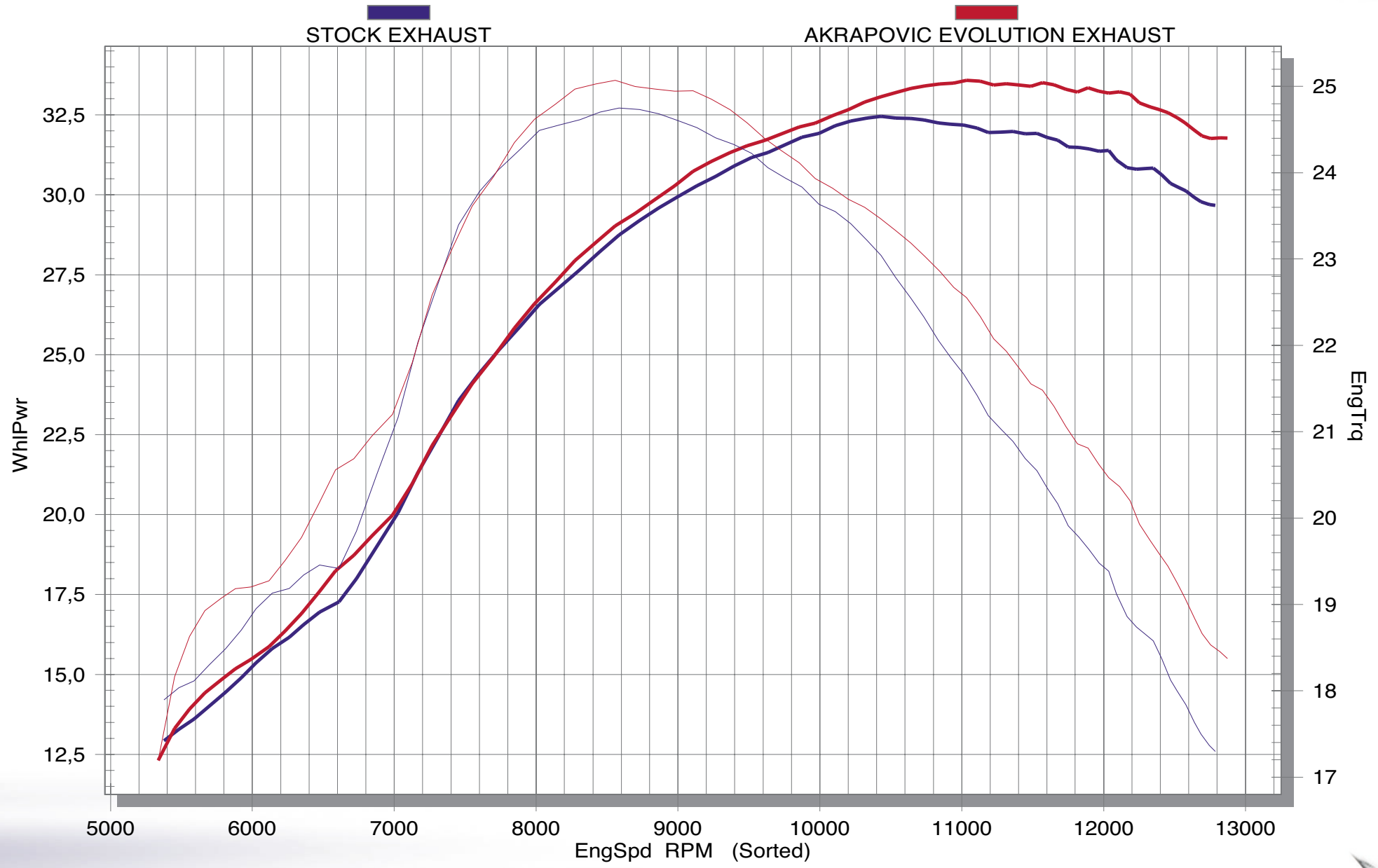

Off-Road Program



Akrapovic Exhaust System Technology copyright 2004, all rights reserved