



Suzuki GSX-R 600 (2004)

Bolt-On Exhaust System

Akrapovic Bolt-On Exhaust System

for the suzuki GSX-R 600 (2004)

Akrapovic BOLT-ON and Slip-On systems are the first level of exhaust system modification. They are user-friendly components whose installation does not require any major modification of the motorcycle, and offer an excellent combination of performance and aesthetics at an affordable price.

PERFORMANCE

Measurements of the Akrapovic BOLT-ON system on the SUZUKI GSX-R 600:

Power: despite the minimal modification to the exhaust system, the Akrapovic BOLT-ON offers a substantial boost in performance. The stock power fluctuations up to 5000 rpm are smoothed out, while above 5000 rpm there is a power increase which goes all the way to the top of the rpm range. Of course, maximal increases of power cannot be obtained from a Bolt-On system. Those who are interested in maximum performance should refer to our Racing and Evolution systems.

Torque: the stock torque curve also shows some fluctuation below 5000 rpm, which the Akrapovic system smoothes out almost completely, as well as offering increased torque. Also, the drop-out at 5600 rpm is filled. The system is intended for riders who do not require a drastic increase in performance, as the consistent increase follows the stock curve.

CONFIGURATION

The BOLT-ON system is made of state-of-the-art materials – the inner perforated sleeve and end cap are made of titanium, while the front rosette is made of special high-quality CNC-machined billet aluminum in order to provide lower weight, compactness and durability.

The muffler outer sleeve is available in either popular carbon-fiber or titanium. The muffler is attached to the stock muffler bracket using an Akrapovic carbon-fiber clamp. The BOLT-ON system also includes titanium bolts which replace the stock bolts, and special temperature-resistant bolt sealant which prevents the bolts from becoming unseated.

| | PERFORMANCE | | |
|--|---------------|---------------|----------------------|
| | stock | AKRAPOVIC | max. increased power |
| max. rear wheel power HP / rpm (measured on SuperFlow Cycle Dyn) | 104.4 / 13100 | 107.1 / 13400 | 3.2 / 13500 |

| | CONFIGURATION | | |
|------------|---------------|-----------|-----------|
| | header tubes | collector | link pipe |
| material | - | - | - |
| tube shape | - | - | - |

| | | | |
|-------------------------------------|-------------------------|--|-------------------------------|
| interference crossover tubes | - | lambda sensor | - |
| header tube inner sleeves | - | header tube flanges | - |
| header tubes - collector connection | - | collector / header tube - link pipe connection | - |
| link pipe - muffler connection | BOLT-ON | muffler inlet cap /outlet cap | ALU CNC MACHINED/ TITANIUM |
| muffler metal interior | TITANIUM | muffler outer sleeve | TITANIUM / CARBON-FIBER |
| muffler clamp | 1x CARBON-FIBER ROAD | muffler bracket | - |
| noise damper | - | heat shield | - |

| OPTIONS | | | | |
|-----------|--------------|-------------------------|-----------------|-------------|
| link pipe | noise damper | muffler outer sleeve | muffler bracket | heat shield |
| - | - | TITANIUM / CARBON-FIBER | - | - |

| | ADDITIONAL DATA | | |
|---------------------------|-----------------|-----------|------------|
| | stock | AKRAPOVIC | difference |
| weight comparison (kg) | 3.78 | 1.67 | 2.11 |

| | stock | AKRAPOVIC |
|---|----------------------------------|-------------------|
| | noise measurements (dB / rpm) | 89 / 5500 |
| possibility of periodic service without removing A.E.S. | oil YES | oil filter YES |
| legal for street use | NO | |

Technical specifications of Akrapovic exhaust systems and related products subject to change without notice.

Akrapovic Bolt-On Exhaust System for the Suzuki GSX-R 600 (2004)

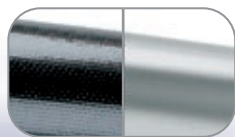

The outer sleeve is available in carbon-fiber or titanium



CARBON-FIBER
MUFFLER CLAMP

Road
Program

Akrapovic Bolt-On Exhaust System for the suzuki GSX-R 600 (2004)



Akrapovic Exhaust System Technology copyright 2004, all rights reserved

Road
Program

Product code: 100315 (S-S10B01-C), 100317 (S-S10B01-T)

Akrapovic Bolt-On Exhaust System for the suzuki GSX-R 600 (2004)



Akrapovic Exhaust System Technology copyright 2004, all rights reserved

Road Program

Akrapovic Bolt-On Exhaust System

for the suzuki GSX-R 600 (2004)

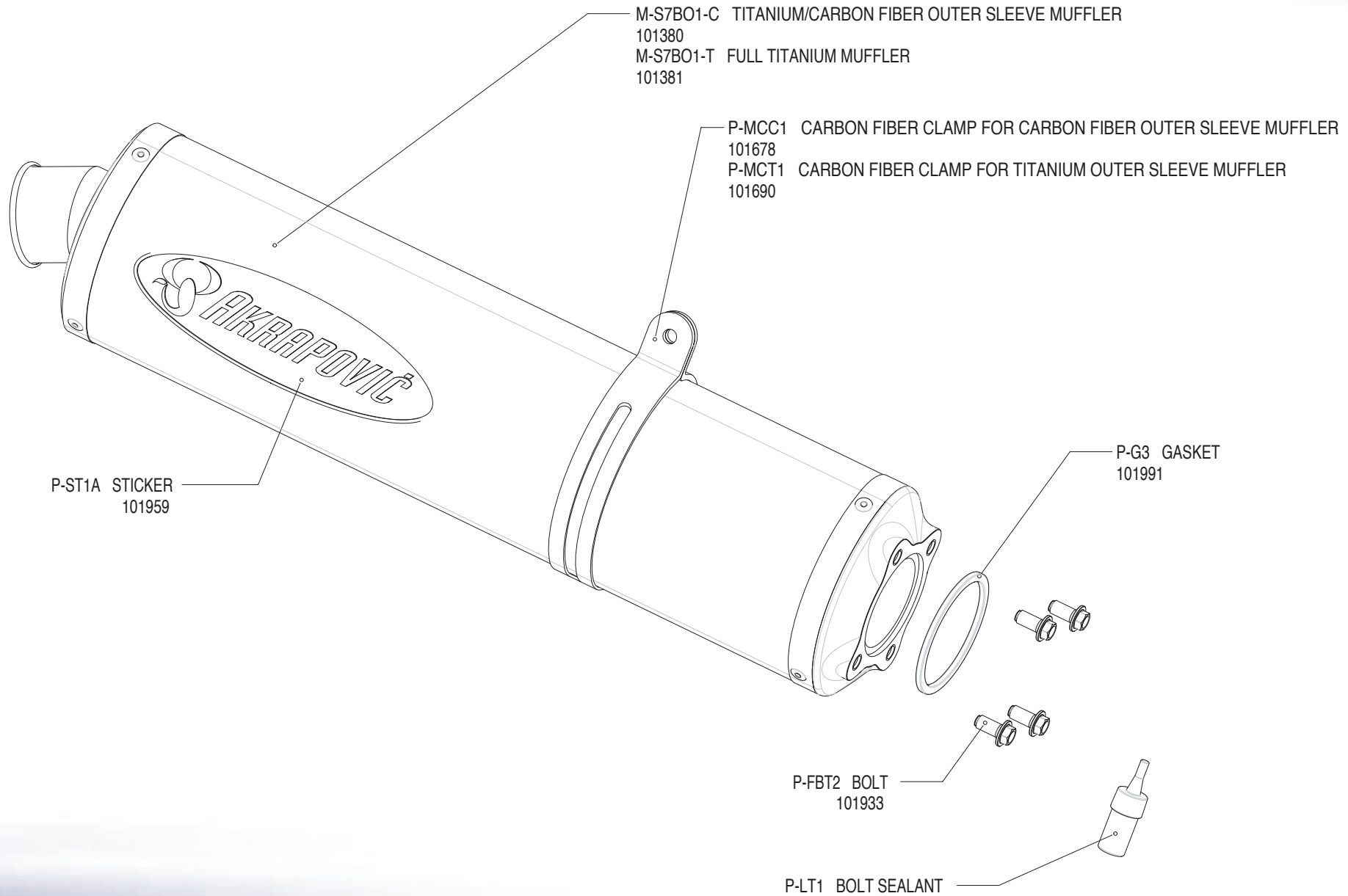

Akrapovic Exhaust System Technology copyright 2004, all rights reserved

Road Program



Akrapovic Bolt-On Exhaust System for the Suzuki GSX-R 600 (2004)

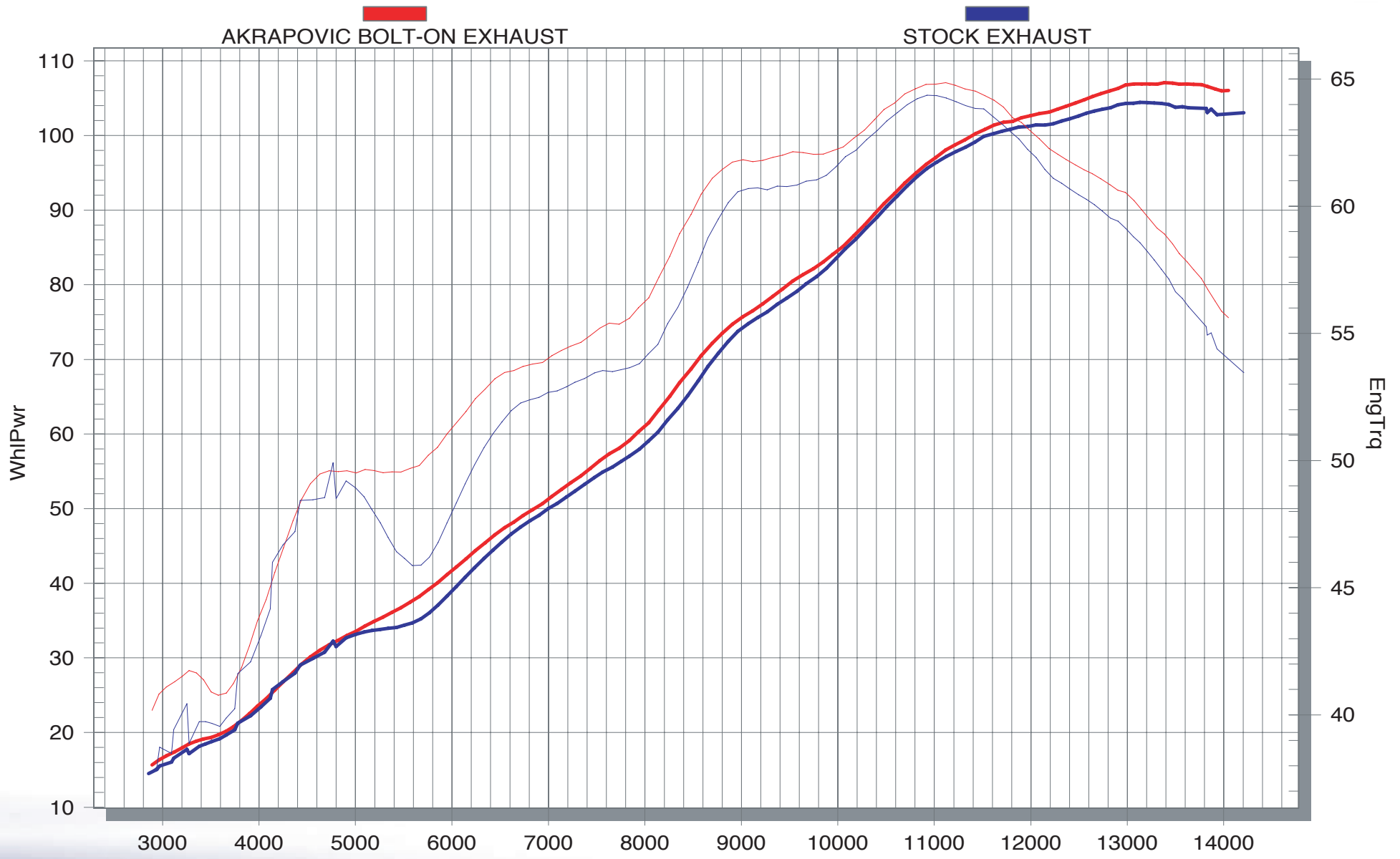

Akrapovic Exhaust System Technology copyright 2004, all rights reserved

Road Program

