



Suzuki GSX-R 1000 (2003)

Bolt-On Exhaust System

Akrapovic Bolt-On Exhaust System

for the Suzuki GSX-R 1000 (2003)

There's a new predator in the asphalt jungle which is currently at the top of the food chain in the 1-liter class. The competition never rests, but they have to compete with the state-of-the-art 2003 GSX-R, which combines brute force with excellent handling. If you're up to the test, the 2003 GSX-R 1000 challenges you to try your courage.

GOAL

The character of the GSX-R is obvious: a two-wheeled racing beast. For those who want nothing less than maximum racetrack performance, the Akrapovic RACING and EVOLUTION complete exhaust systems are more suitable. But for those who see the GSX-R as a technical masterpiece to be proudly displayed and enjoyed rather than pushed to the absolute physical limit, we offer the Akrapovic BOLT-ON system. With this system you receive increased performance, enhanced engine sound and good looks with a minimal modification to the bike.

ABOUT AKRAPOVIC BOLT-ON SYSTEMS:

The design of the BOLT-ON system is based on simple installation which can be performed by the customer, without having to remove or modify any of the exterior parts of the motorcycle. It is also a uniquely designed component which fits only on the bike it was developed for. Installation is performed simply by unscrewing the bolts from the stock muffler and attaching the BOLT-ON system.

The system is made of top-quality materials – the inner perforated sleeve and end cap are made of titanium, while the front rosette is CNC machined from billet aluminum in order to obtain minimum weight and maximum compactness and durability.

The outer sleeve is available in either carbon-fiber or titanium, in order to suit your particular preference. The muffler clamp is made entirely of carbon-fiber. The BOLT-ON kit also contains titanium bolts which replace the stock bolts, and a special temperature-resistant adhesive in order to prevent the bolts from unseating.

Measurements of the BOLT-ON system for the Suzuki GSX-R 1000:

•power:

The Akrapovic BOLT-ON system will not have a drastic effect on engine performance. However, it does complement the engine extremely well, adding a substantial amount of power from the bottom to the top of the rpm range. This means smoother acceleration with more available power, which is the basic purpose of first-level tuning of the exhaust system.

•torque:

The torque curve is similar to the power curve. Additional torque is provided throughout almost the entire rpm range (with a larger boost in pulling power at around 2000 rpm). The torque band is also smoother from 4000 rpm all the way to the overrev range.

The Akrapovic BOLT-ON system is an excellent choice for recreational riders who want improved performance to complement their riding style. This improvement is also reflected in the aesthetic qualities which it adds to the bike, including the improved sound of the Akrapovic component which will make your Suzuki recognizable even before the Akrapovic sticker on the muffler comes into view.

Last but not least are the weight savings. All Akrapovic exhaust systems are designed to lower the overall weight of the motorcycle, through the use of high-tech materials and production processes. With the Akrapovic BOLT-ON system the weight savings are more than substantial, coming in at over 50%.

	stock	AKRAPOVIC	difference
weight comparison	3.25 kg	1.60 kg	1.65 kg
max. rear wheel power	151.1 HP / 10850 RPM	155.1 HP / 11380 RPM	5.6 HP / 11780 RPM*
noise measurement	93 db / 5400 RPM	98 db / 5400 RPM	5 db / 5400 RPM
legal for street use	NO		

*MAXIMUM MEASURED POWER DIFFERENCE

Technical specifications of Akrapovic exhaust systems and related products subject to change without notice.

Product code: S-10BO1-C, S-S10BO1-T

Akrapovic Bolt-On Exhaust System for the Suzuki GSX-R 1000 (2003)



CARBON-FIBER
MUFFLER CLAMP

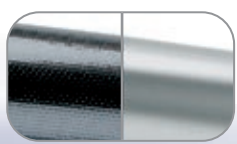

The outer sleeve is available in carbon-fiber or titanium



BOLT SEALANT

Road Program

Product code: S-10BO1-C, S-S10BO1-T



Akrapovic Bolt-On Exhaust System for the Suzuki GSX-R 1000 (2003)



Akrapovic Exhaust System Technology copyright 2003, all rights reserved

Road
Program

Product code: S-10BO1-C, S-S10BO1-T

Akrapovic Bolt-On Exhaust System for the Suzuki GSX-R 1000 (2003)



Akrapovic Exhaust System Technology copyright 2003, all rights reserved

Road
Program

Product code: S-10BO1-C, S-S10BO1-T



Akrapovic Bolt-On Exhaust System for the Suzuki GSX 1000R (2003)

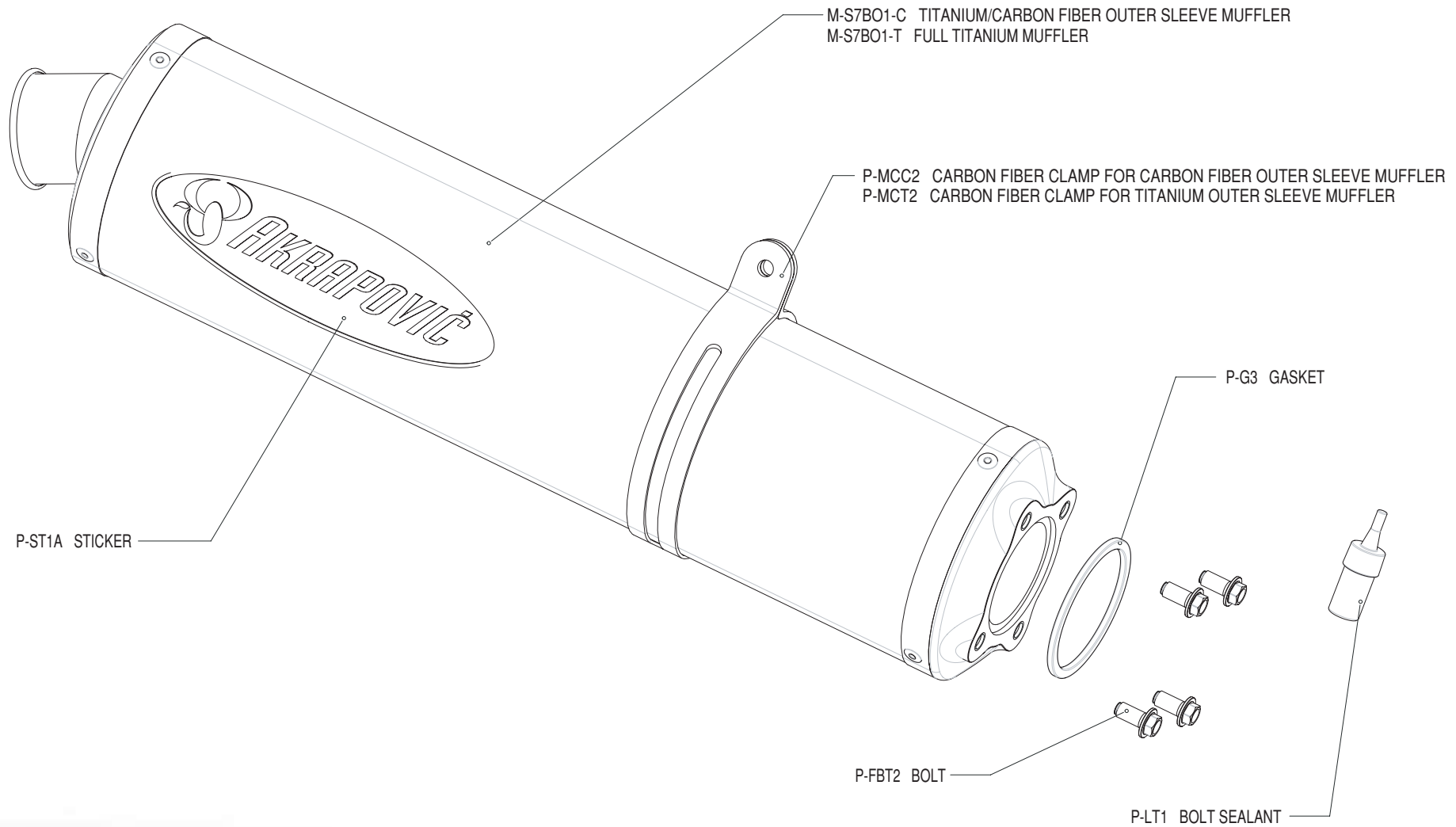

Akrapovic Exhaust System Technology copyright 2003, all rights reserved

Road
Program



Akrapovic Bolt-On Exhaust System for the Suzuki GSX-R 1000 (2003)

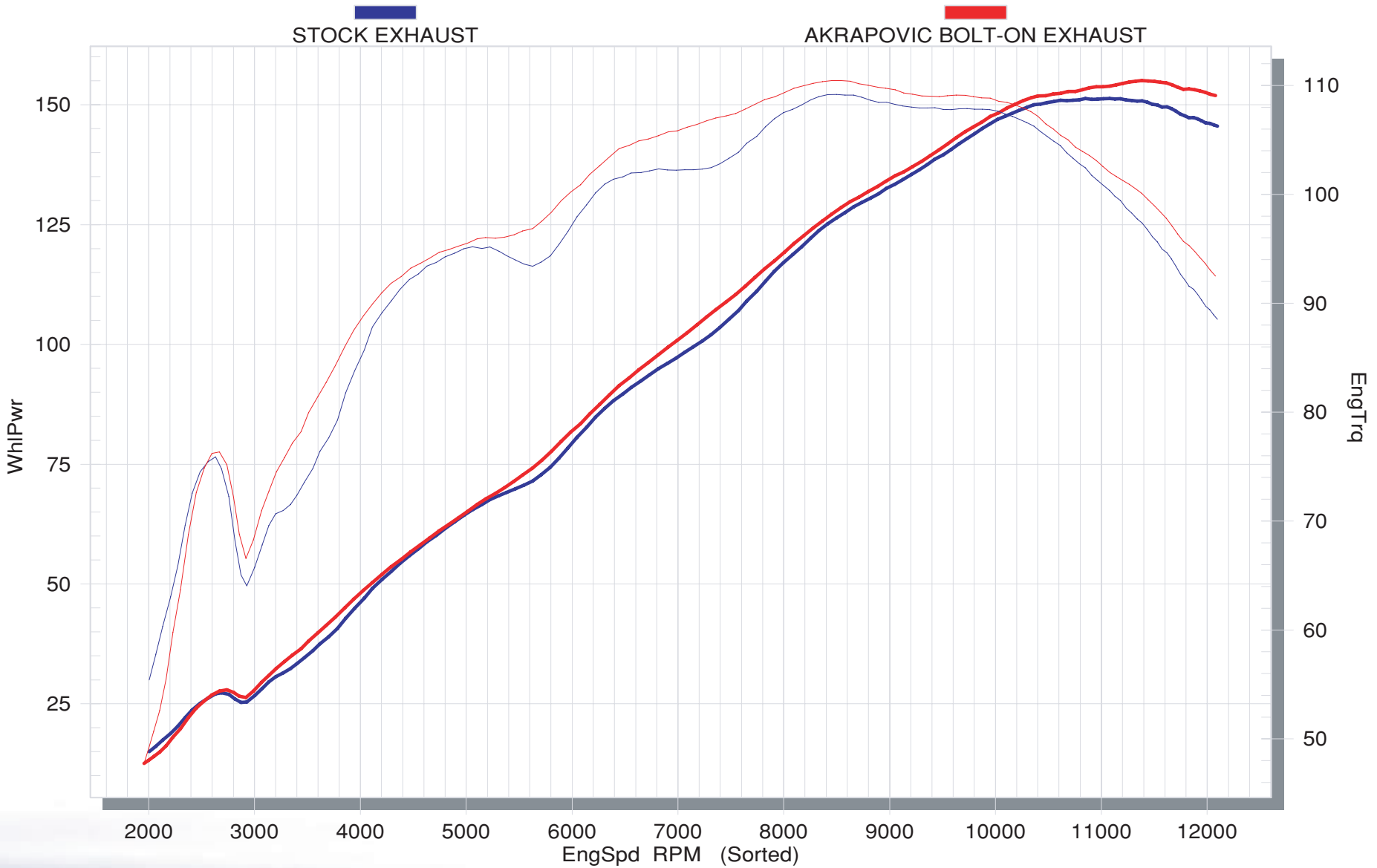

Akrapovic Exhaust System Technology copyright 2003, all rights reserved

Road Program

Product code: S-10BO1-C, S-S10BO1-T

